

Sensor – Throttle Position (2.3 DOHC) – Remove And Install (23 325 0)

Remove

⚠ CAUTION: Disconnect the battery negative lead.

⚠ CAUTION: When disconnecting the multiplugs contained in this operation, do not pull on the wiring; pull on the multiplug body.

1. Disconnect the IAT sensor multiplug.

Depress the retainer and disconnect the multiplug.

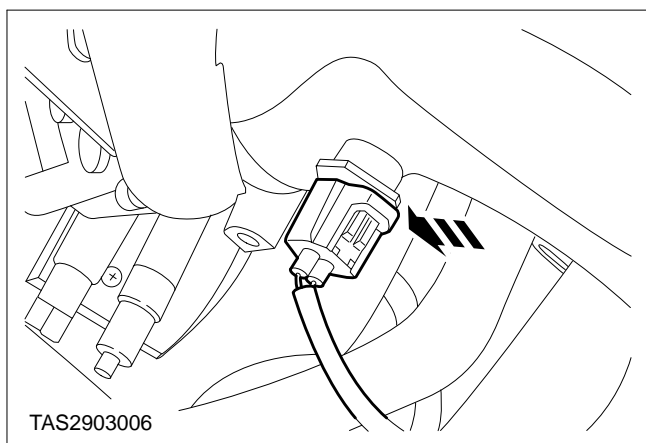

2. Remove the intake hose.

1 Slacken the hose clips each end of the intake trunking.

2 Remove the intake hose.

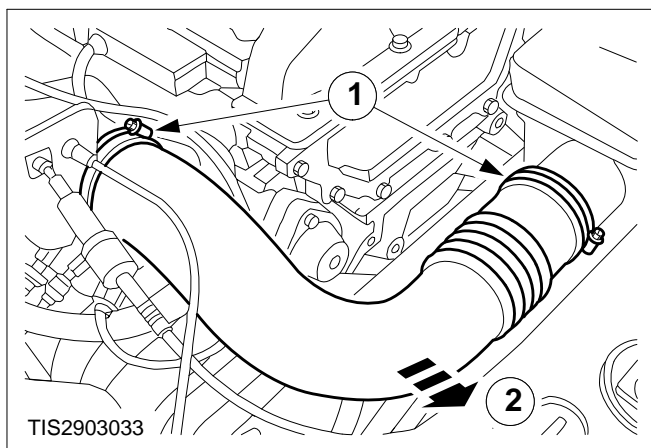

3. Disconnect the vacuum pipe from the throttle housing.

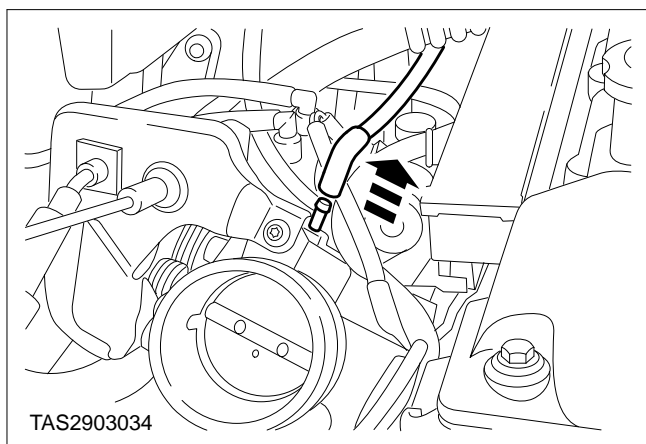

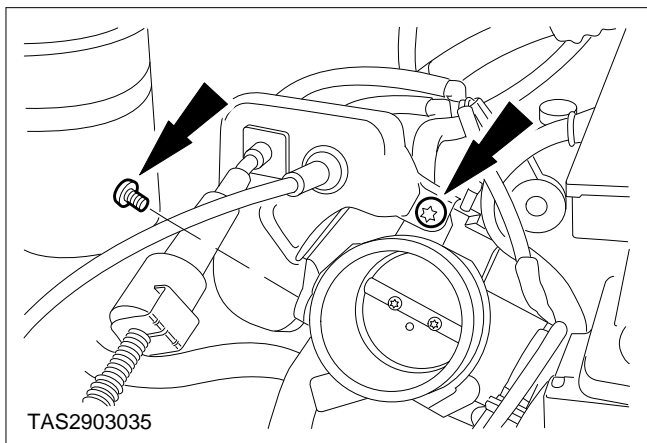

- 4. Remove the two accelerator cable bracket Torx retaining screws.**

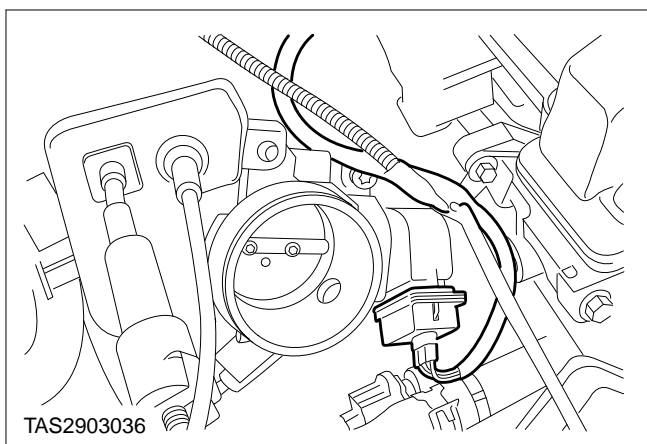

- 5. Disconnect the TP sensor multiplug.**
Depress the retainer and disconnect the multiplug.

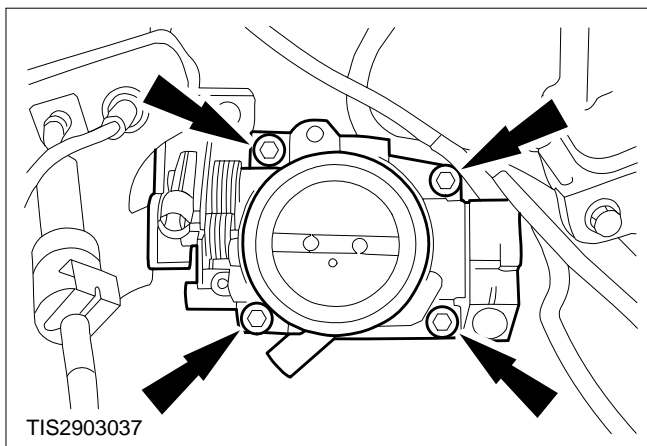

Throttle Body – Remove (23 198 0)

- 6. Detach the throttle body.**
- Remove the four Torx retaining screws and detach the throttle body.
 - Disconnect the accelerator cables to remove the throttle body.

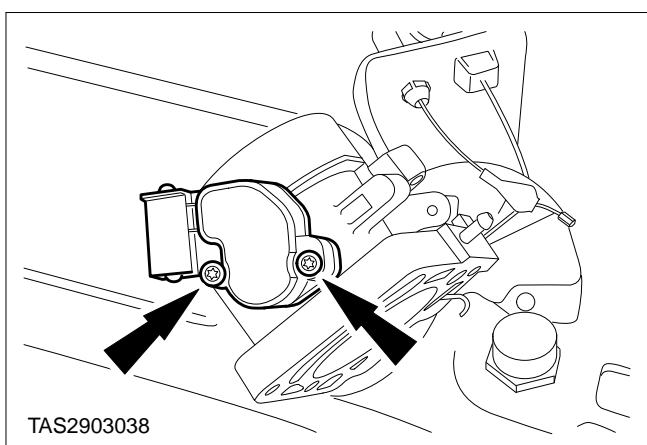

- 7. Remove the TP sensor (two screws).**

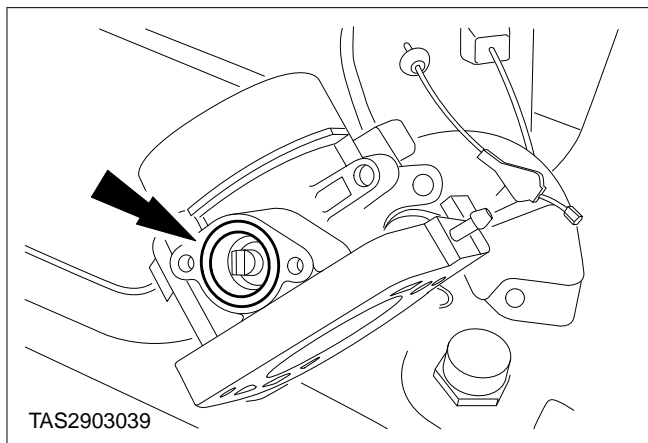

Install

NOTE: Inspect the O-rings and rubber gaskets, these should be renewed if distorted/damaged.

8. Refit the components in reverse order.

Ensure that the TP sensor is correctly located on the throttle plate.

Throttle Body – Install (23 198 0)

