

Sensor – Heated Oxygen (Pre-Catalyst) (DOHC Variants) – Remove and Install (29 200 0)

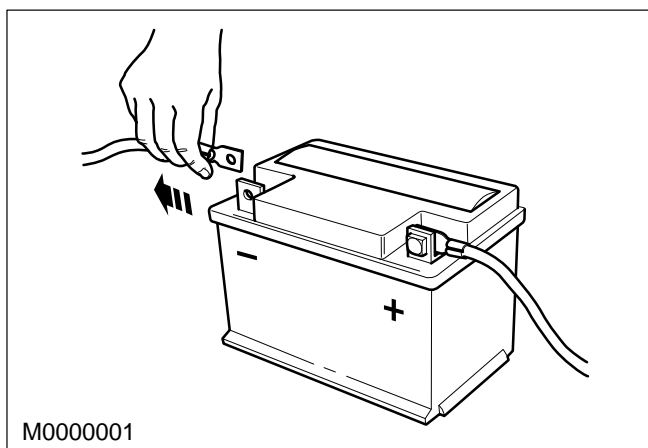

Remove

1. Disconnect the battery earth lead.

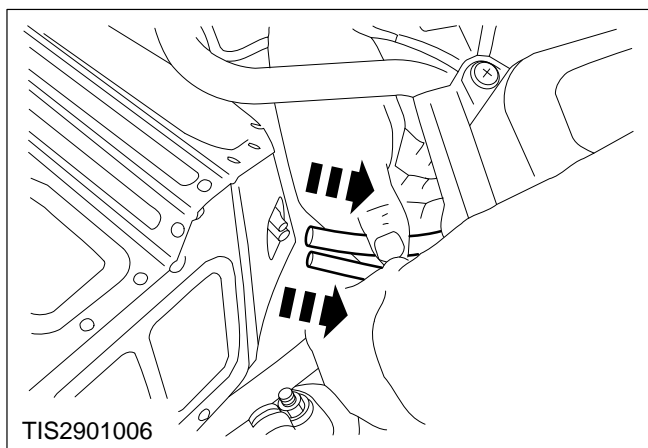

2. Disconnect the Pressure transducer EGR system hoses.

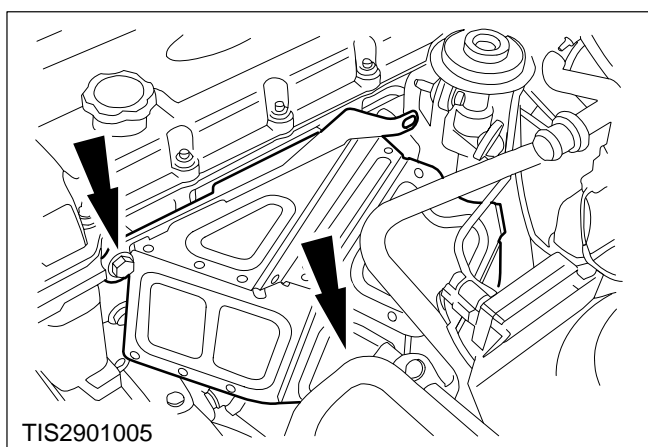

⚠ WARNING: The exhaust manifold and heatshield may be hot.

3. Unscrew the bolts and remove the heatshield.

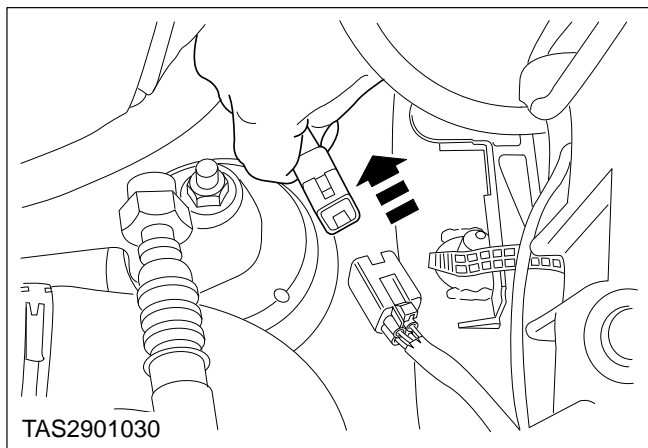

⚠ CAUTION: Do not pull on the wiring; pull on the multiplug body.

4. Disconnect the HO2S multiplug.

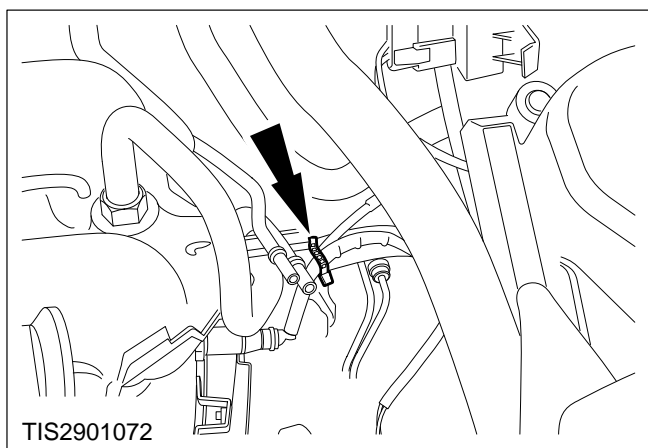

5. Carefully cut the HO2S loom tie.

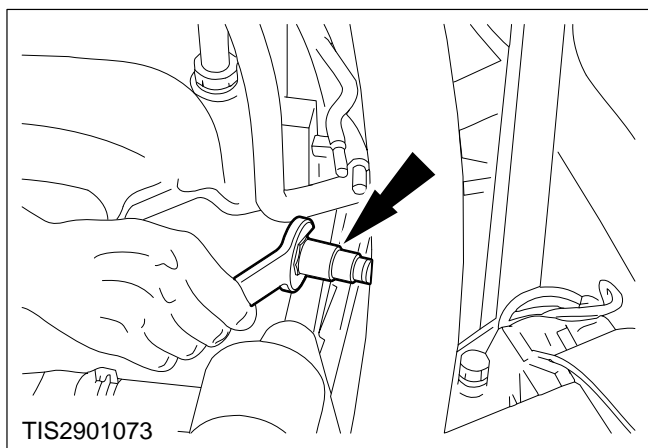

6. Unscrew the HO2S.

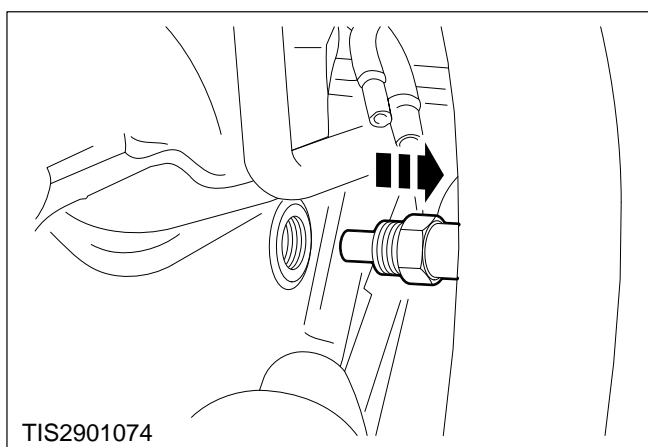

7. Remove the HO2S.

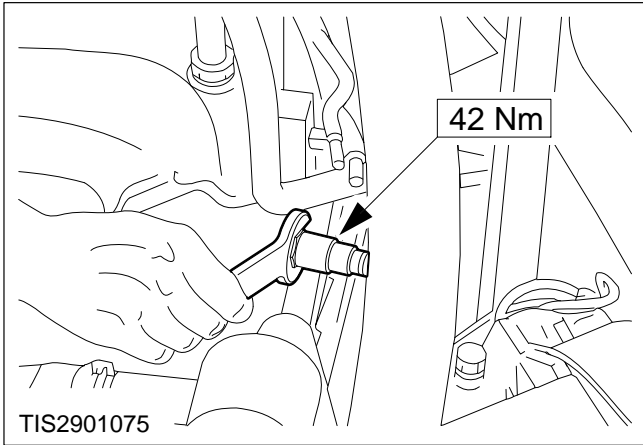

Install

8. Refit the components in reverse order.