

Module – Powertrain Control (Petrol Variants) – Remove and Install (29 200 0)

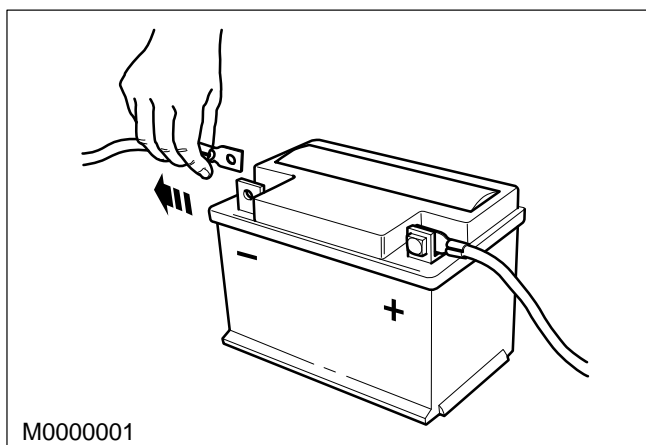

Remove

1. Disconnect the battery earth lead.

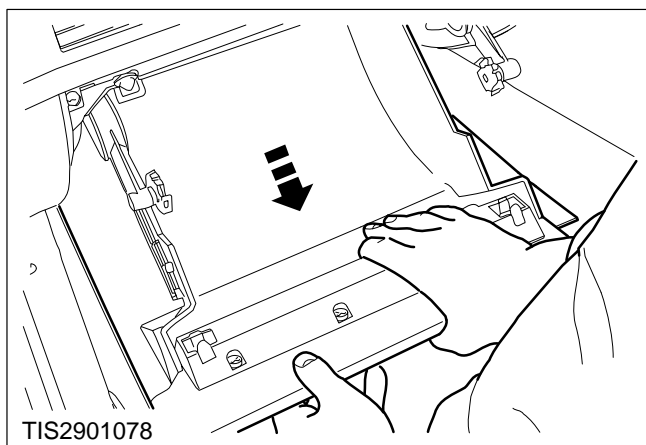

2. Remove the glove box.

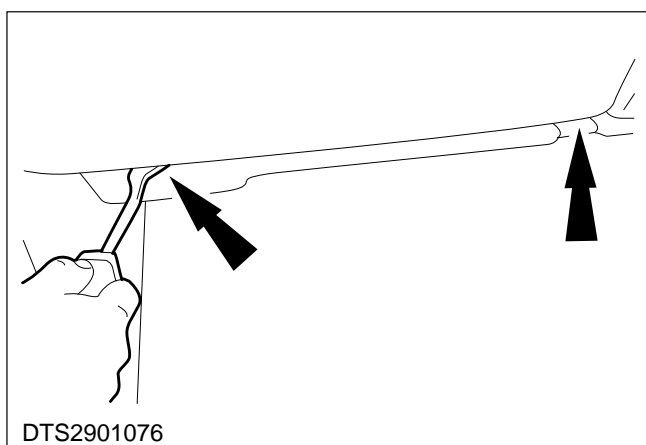

3. Remove the trim panel fasteners.

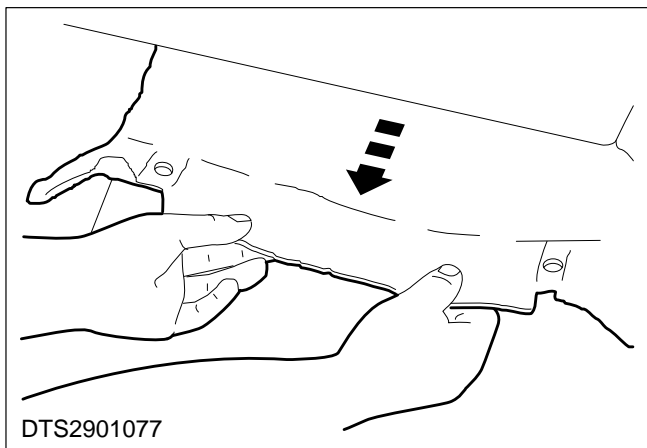

4. Lower the trim panel.

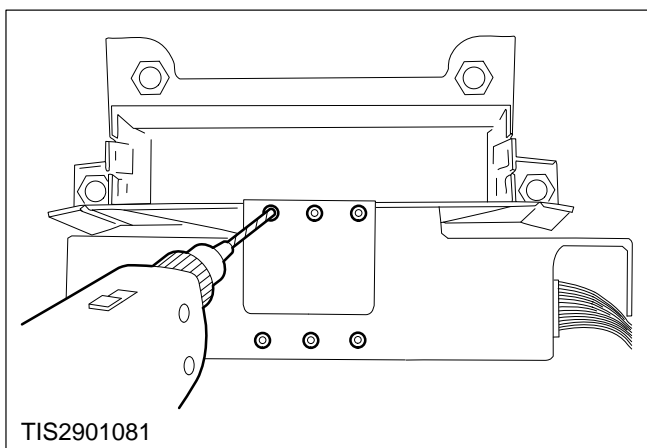

⚠ CAUTION: Do not allow the drill to make contact with the PCM casing.

5. Carefully drill out the security cover retaining rivets.

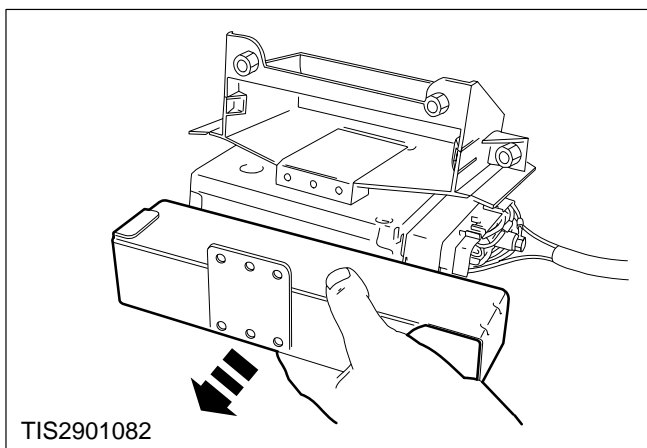

6. Remove the security cover.

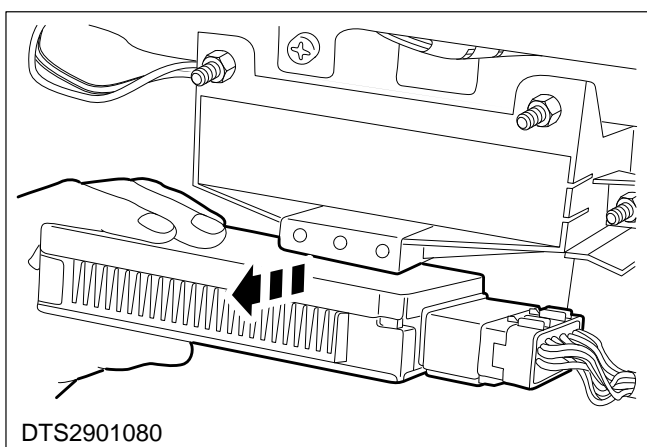

7. Remove the PCM from the bracket.

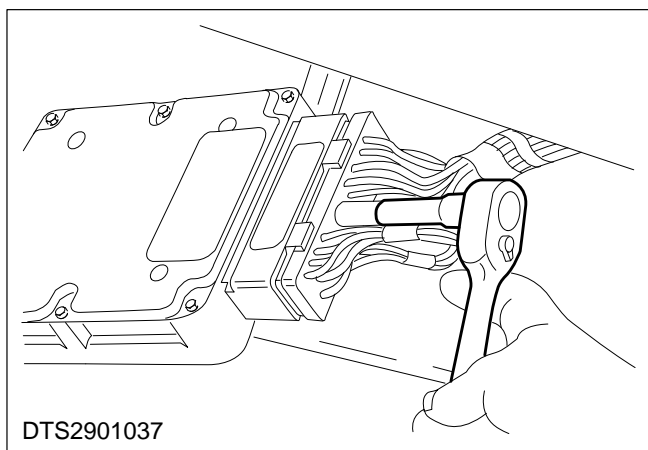

⚠ CAUTION: Do not pull on the wiring; pull on the multiplug body.

8. **Unscrew the retaining bolt and disconnect the PCM multiplug.**
9. **Remove the PCM.**

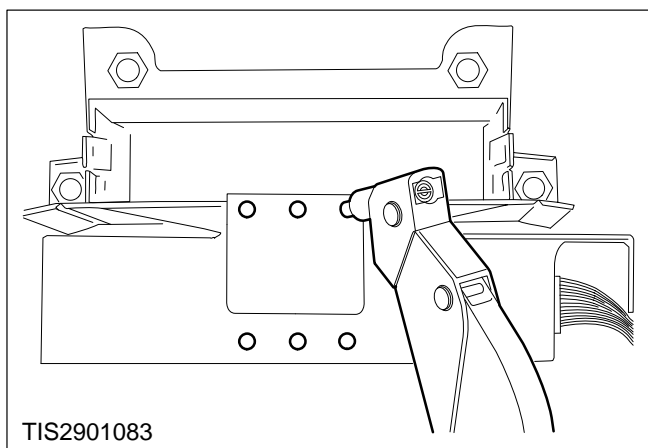

Install

⚠ CAUTION: Ensure the PCM multiplug is refitted correctly to avoid damage to the module pins.

NOTE: Always use rivets when refitting the security cover in order to maintain PATS integrity.

10. **Refit the components in reverse order.**